

Dear,

This folder gives you the opportunity to get acquainted with Kreon “tools of light” (TOL) and Kreon “ceiling solutions” (CS).

It contains background information on Kreon, our realisations, our novelties, new concepts, our new HQ and info about the acquisition of Belux by Kreon in 2016.

In addition to the printed press release we also offer you the digital files.
PDF files of the press texts, JPEG product & project pictures and PDF's from all our brochures.

These digital files are available at:

<http://www.kreon.com/en/int/press>

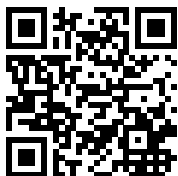

Kind regards

Philippe van Doormaal
Global Marketing Communication Director

kreon

company

Kreon is a global organisation producing architectural interior lighting products (tools of light) and complete metal ceiling solutions (ceiling solutions) for beautiful interiors since 1982.

The basis for Kreon's design is a very clear characteristic visualisation of the company's philosophy: purity and simplicity. Wherever possible we refer to pure three-dimensional architectural shapes.

Kreon offers timeless lighting concepts that are designed to form an integral part of architecture or to create a dialogue with a structure. The collection includes an array of downlights, uplights and sidelights which disappear into ceilings, floors and walls harmoniously. We always respect the recessed position of the lamp source, creating an emotional feeling of light and preventing an uncomfortable glare situation.

Lighting concepts are implemented at the planning stages of the design process by architects, designers and engineers.

Typical applications include residential, hospitality, retail, display and office interiors.

Our major clients are architects and light planners.



Philosophy

Beauty is not created by adding one more detail, it is conceived by removing the last.

The design of our collection represents a way of thinking that reduces each product to the essential components without compromise. Luminance and illumination are the primary goals. The luminaire, a detail that can reflect and integrate within architecture with the purest form that will enhance and add value to its environment, requires a deep understanding of the intrinsic nature and unified components of architectural styles. These components can be condensed into basic forms, which Kreon exploits within its products. This approach to design requires that the details of an object are not merely decorative, but are key to the essence of the product as a whole. Kreon products, in their simplest forms, do not result in austere minimalism, but in architectural objects that communicate with space, regardless of style. This, combined with careful planning, represents the true meaning of "architectural lighting".

Kreon, purity in light gives you the opportunity to create the conditions that allow the beauty of architecture to surface.

Design

Kreon epitomises the language of form in present-day architecture, an architecture based on right angles and lines. It is to this same sober architecture that the appliances owe their universal and timeless character. Instead of basing its designs on the form of the lighting devices and the radius of the light they diffuse, Kreon is resolutely determined to choose architecture. Because Kreon bases its work on architectural design, it can enter into dialogue with architecture as an equal partner. Kreon appliances are not foreign elements, but merge with the architecture. The product has a minimal presence and leaves it to light itself to steal the show. The forms are simple and austere. Kreon lighting appliances are sober and do not monopolise attention. An architect does not want lighting appliances, but light, atmosphere and comfort. Kreon provides the purity in light.

Kristof Pycke
Art Director



kreon

project pictures TOL

Project: Private residence, Paris, France
Photographer: Serge Brison



If you want to use this information, please contact Philippe van Doormaal.
marketing@kreon.com, tel: +32 (0)89 81 97 80

Project: Ascot, London, United Kingdom
Photographer: Arne Jennard



kreon

project pictures TOL

Project: Private residence, Laren, the Netherlands
Photographer: Serge Brison



If you want to use this information, please contact Philippe van Doormaal.
marketing@kreon.com, tel: +32 (0)89 81 97 80

kreon

project pictures TOL

Project: Euronics, Wommelgem, Belgium
Photographer: Arne Jennard



kreon

project picturese TOL

Project: Private residence, Maaseik, Belgium
Photographer: Serge Brison



Kreon modular ceilings aim to materialise simplicity, unity and functionality within its design.

Simplicity must not be the result of an uncritical reduction. Instead, it should be the convergence and synthesis of the complex requirements imposed on ceiling solutions by contemporary architecture. Taking its cue from this concept, Kreon ceiling solutions do more than just span a room. It offers a unique solution for the integration of building service systems that need to be accommodated in the ceiling: lighting, ventilation, cooling, heating, fire protection and much more. Kreon's most pursued objective is to offer unity in design translated through technical solutions.

Design that gives prominence to simplicity, permanence and calmness requires precision so as not to become trivial. The more one condenses, omits and simplifies, the more the significance of the detail is increased. Unity and simplicity of details are the very ones to concur to great architecture.

Kristof Pycke
Art Director



Project: Private residence, Opglabbeek, Belgium
Photographer: Serge Brison



Project: Audi Delorge, Hasselt, Belgium
Photographer: Kreon



Project: Advocatenkantoor Cottyn, Aalst, Belgium
Photographer: Serge Brison



Project: Euronics, Wommelgem, Belgium
Photographer: Arne Jennard



Kreon's new HQ

In 2016 Kreon moved to its new global headquarters in Opglabbeek, Belgium.

The design of the 3000m² building is the brainchild of Kreon's art director, who has been responsible for capturing and conveying the philosophy in anything at Kreon for the last 15 years.

Creativity and technical resolve are at the heart of Kreon culture and this has been reflected in the planning of the new building where particular attention is focused on zones for research and development, and state-of-the-art photometry.

The scale of the new building provides an opportunity to showcase the entire Kreon range in the functional and architectural way that it is intended. This allows full expression of the "Tools of Light" and "Ceiling Solutions" product families.

The increased space has allowed the integration of all internal operations under one roof which will facilitate increased interaction and communication between departments and customers.

Kreon sees this as a milestone in the history of the organisation and holds it as a fantastic opportunity to communicate and inspire employees and customers alike. A space where ideas can blossom and flourish.



kreon

belux

Kreon acquires Belux

January 2016, Kreon became the new owner of Belux, the renowned Swiss-based designer and manufacturer of sophisticated lighting solutions.

Founded in Switzerland in 1970, Belux has worked together with such prominent international designers as Frank Gehry, Naoto Fukasawa, Ronan & Erwan Bouroullec, Herzog & de Meuron and Hella Jongerius to develop and produce a range of remarkable, poetic designs including Cloud, Lantern, Jingzi and Blossom.

Kreon is a family-owned business based in Belgium. Belux represents an ideal addition to the Belgian lighting expert and will enrich the company in many areas. Kreon plans to maintain the brand name, product strategy and orientation of Belux and will operate in the market with the dual brands Kreon and Belux.



Kreon offices worldwide:

Kreon HQ

Industrieweg Noord 1152
3660 Opglabbeek
Belgium
Tel +32 89 81 97 80
Fax +32 89 81 97 90
www.kreon.com
mailbox@kreon.com

Kreon Austria

Kärntner Ring 4
1010 Wien
Austria
Tel +43 1 715 44 25
austria@kreon.com

Kreon France

5, rue d'Aboukir
75002 Paris
France
Tel +33 1 44 50 53 54
Fax +33 1 44 50 53 56
france@kreon.com

Kreon Germany

Brühler Straße 11-13
50968 Köln
Germany
Tel +49 221 937 22 0
Fax +49 221 937 22 22
germany@kreon.com

Kreon Italy

Via V. Forcella 5
20144 Milano
Italy
Tel +39 02 89 42 08 46
Fax +39 02 89 42 87 85
italy@kreon.com

Kreon UK

67 Maltings Place
169 Tower Bridge Road
London
SE1 3LJ
United Kingdom
Tel +44 (0)20 7740 2112
Fax +44 (0)20 7740 2923
uk@kreon.com

Kreon Spain

Ángel Guimera 7-9 local C
Barcelona 08017
Spain
Tel +34 600 462 551
spain@kreon.com

Kreon Middle East

Dubai Airport Free Zone Area (DAFZA)
West Wing 6 (W6)
Office 6 WA 420
P.O. Box 293845
Dubai
United Arab Emirates
Tel +971 4 6091 355
Tel +971 4 6091 656
Fax +971 4 6091 357
middle.east@kreon.com

Kreon South East Asia

63a Club Street
Singapore 069 437
Tel +65 62 22 33 93
Fax +65 62 22 33 03
singapore@kreon.com

Kreon Turkey

Sehit Murat Demirli Cad. Resadiye Yolu 76
Alemdag-Ümraniye 34794
Istanbul
Turkey
Tel +90 216 430 86 00
Fax +90 216 430 86 96
turkey@kreon.com

Kreon Inc.

North America & Canada
999 South Oyster Bay Road
Building 105
Bethpage, NY 11714, USA
Tel +1 516 470 9522
usa@kreon.com

Kreon China

655 Changhua road, ground floor S1
JingAn district
200040 Shanghai
P.R. China

Kreon showrooms worldwide:

Creative Space HQ

Industrieweg Noord 1152
3660 Opglabbeek
Belgium
belgium@kreon.com

Creative Space Vienna

Kärntner Ring 4
1010 Wien
Austria
Tel +43 1 715 44 25
austria@kreon.com

Creative Space Paris

5, rue d'Aboukir
75002 Paris
France
Tel +33 1 44 50 53 54
Fax +33 1 44 50 53 56
france@kreon.com

Creative Space Cologne

Brühler Straße 11-13
50968 Köln
Germany
Tel +49 221 937 22 0
Fax +49 221 937 22 22
germany@kreon.com

Creative Space Milan

Via V. Forcella 5
20144 Milano
Italy
Tel +39 02 89 42 08 46
Fax +39 02 89 42 87 85
italy@kreon.com

Creative Space Singapore

63a Club Street
Singapore 069 437
Republic of Singapore
Tel +65 62 22 33 93
Fax +65 62 22 33 03
singapore@kreon.com

Creative Space Barcelona

Àngel Guimera 7-9 local C
Barcelona 08017
Spain
Tel +34 600 462 551
spain@kreon.com

Creative Space London

67 Maltings Place
169 Tower Bridge Road
London
SE1 3LJ
United Kingdom
Tel +44 (0)20 7740 2112
Fax +44 (0)20 7740 2923
uk@kreon.com

Creative Space Shanghai

655 Changhua road, ground floor S1
JingAn district
200040 Shanghai
P.R. China

Tools of light Novelties

Last year we saw the reshaping and technological upgrade of our design classic: Diapason. This new range harks back to the original concept but has been redesigned with contemporary styling and state-of-the-art LED technology to provide a superior tool for architectural and display lighting.

Still in its conceptual phase at Light+Building 2014, Esprit has matured into a multi-directional light cylinder which floats on a stem that emanates from ceiling or floor to provide perfect accent lighting. Its minimal design and stylish finish are key elements of the Esprit spotlight range.

In the Fuga range, the same expressions of minimization and finish are combined to create a pendant luminaire which can be adapted and combined to form an architectural element within space.

Cana brings all features of the Kreon downlight families into a new profile system that reinforces the "Tools of Light" concept by utilizing the available forms and components and placing them into a flexible and functional channel system. Additionally, the latest size in the pure cylindrical projector range Holon, can be added in the profile system for accent lighting. This projector will be shown both as part of the Cana profile system, and as a ceiling mounted luminaire. The new Holon 80 provides a solution for technical accent and display lighting requirements.

In the external segment, Kreon is presenting the Raga series which distinguishes itself by its pure form, discreet lit effect and the natural beauty of the marbles which have been carefully selected to create these sculptural pieces.

Alongside Raga, Kreon introduces Wabi. A range of lockable projectors for external accent lighting in a robust and durable form.

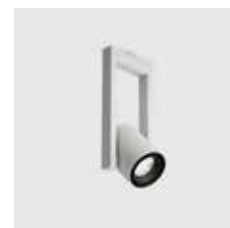

Diapason 80

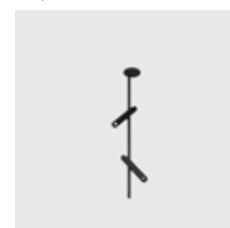

Esprit ceiling

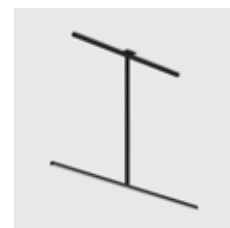

Fuga



Prologe 120 double in-Cana



Raga horizontal



Wabi

Ceiling solutions novelties

With the new ceiling concept, Rytmi, Kreon CS focuses on adding rhythm to a space and inducing a composition of mechanisms. Rytmi is a distinctive modular linear ceiling system with the unique attribute that it allows for the integration of building service components that are required to provide a technical functionality to the ceiling surface.

The distance between the blades can be chosen to accommodate the specific requirements of the project, and facilitate the application of click-in tiles with specific service attributes in customized sizes providing a freedom of choice that gives the designer the opportunity to create a functional and desirable rhythm across the ceiling surface. Acoustic control functionality has been addressed by the possibility to incorporate sound absorbing materials between the blades in concealed cassettes or as a visual element.

The integration of lighting is simple within the Rytmi ceiling system. The new Cana 40, 80 or 120 system of Kreon have been designed to integrate perfectly between the blades of the Rytmi system to provide discreet accent and display lighting functions.

For applications where a higher degree of ambient lighting is required, Rytmi can integrate the Skytile concept - a uniform luminous and illuminating layer in a convenient modular arrangement. Skytile can be programmed to follow nature's natural lighting cycle, ranging from low light levels and colour temperatures in the morning, high levels at mid-day and again lower during the evening and night.



Rytmi



Skytile

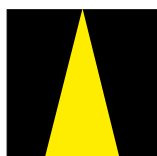

profile systems



cana 40
p. 22



cana 80
p. 23



cana 120
p. 24



projectors



holon 40 fixed
p. 28



holon 40
directional
p. 28



holon 80 fixed
p. 29



holon 80
directional
p. 29



diapason 80
p. 26



esprit
p. 30



wabi 80
p. 31

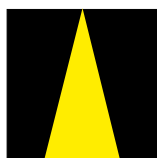

downlights

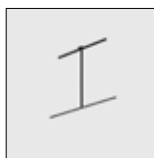

fuga
p. 32



bollards



raga
p. 33

Cana

Creating rhythms and patterns

Cana is a recessed mounted channel to add architectural features in the ceiling plane. By cutting slots in the ceiling, Cana emphasizes the thickness of the ceiling while black internal cover plates make the impression there is a void beyond. Within the channel compositions of light, shape and color can be created.

Available in various widths, 40 – 80 – 120, Cana is a versatile profile system that can offer countless lighting solutions with best in class LED technology. Round or square shaped, fully adjustable downlights can be placed anywhere in the Cana profile. According to the needs of the project, beam angle, CRI and dim protocol can be chosen while the lumen package is in relation with the width of the profile.

To add more flexibility, the slim Cana 40 profile range is expanded with a surface mounted or pendant mounted option. Also a Ligna LED line is added for linear lighting.

Holon 80 directional projector luminaire can easily be fitted into the Cana 80 channel. This is a great feature for accent lighting.

Cana can be used in projects of all kinds. Cana 40 can be used in residential projects, while Cana 80 and 120 are a perfect fit for hospitality, shop or office projects. With this range, the lighting designer receives a fully customizable tool for pure architectural lighting.

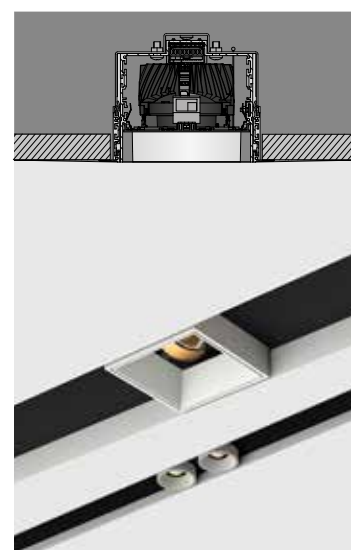

Cana 40

Cana 40 is a slim aluminium profile with an integrated 24V track, and a mat black or white powdercoated finishing. Square or round modules float on a deepened black continuous background, creating rhythm and pattern to the ceiling plane.

The Cana 40 profile is suitable for recessed, surface mounted or pendant installation and can be combined with separate LED light modules or a continuous LED strip Ligna with a colour temperature of 2700K. The combination of light modules is made to measure for the specific needs of each projects and is delivered pre-assembled.



White Prologe 40 in-Cana double
in white recessed mounted profile



White Holon 40 in-Cana single in
black surface mounted profile

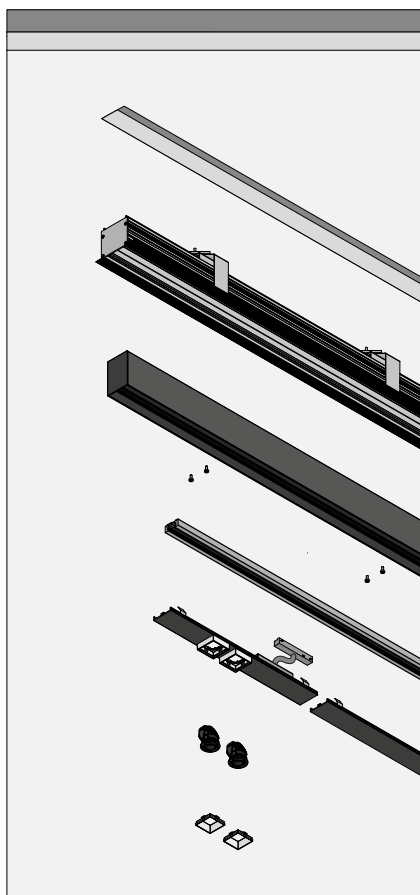

Schematic representation of assembly
Prologe 40 double in-Cana:
plasterkit + profile + luminaire + louvre.



Cana 80

Cana 80 is a recessed profile made of anodised aluminium for use in plastered surfaces. Endless combinations of directional LED light modules, Holon and Prologe, can be placed in the channel. These black or white light modules come in a wide variety of colour temperatures & CRI ratings. Additionally, different reflectors, lenses and dimming protocols are available to meet the needs of each individual project. The combination of light modules is made to measure and is delivered pre-assembled.



Black Prologe 80 in-Cana single in white recessed mounted profile



White Holon 80 in-Cana single in black recessed mounted profile

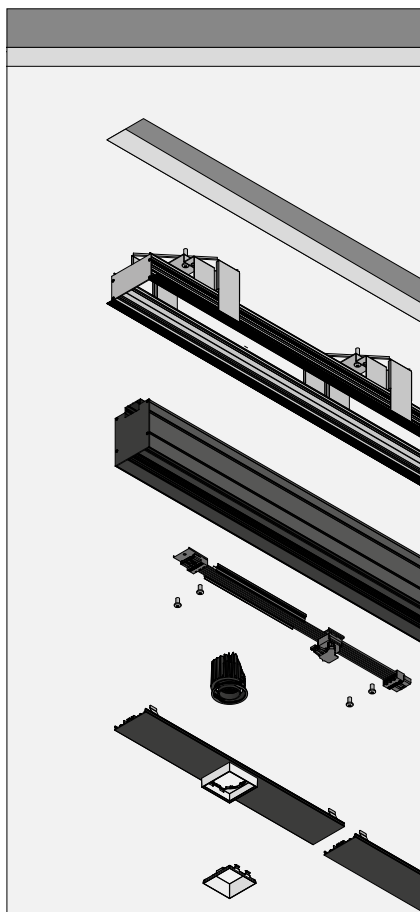

Schematic representation of assembly
Prologe 80 single in-Cana:
plasterkit + luminaire + louvre.



Cana 120

Cana 120, the widest profile in the Cana range. This recessed mounted profile is available in a white or black powdercoated finish. A combination of round or square fully adjustable LED light modules can be fixed in the channel. Together with different optics, dimming protocols, and a wide range of available colour temperatures and CRI ratings for the LED modules, this profile is capable of handling a range of specific project needs.



White Prologe 120 in-Cana single
in black recessed mounted profile



Black Holon 120 in-Cana single
in white recessed mounted profile

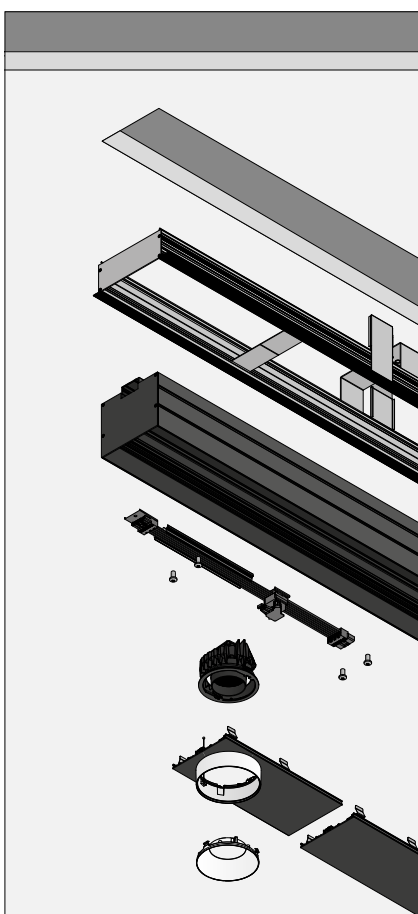

Schematic representation of assembly
Holon 120 single in-Cana:
plasterkit + profile + luminaire + louvre.



Diapason

Diapason re-invented

A quarter of a century after the design classic "Diapason" was launched by Kreon, the timeless piece in lighting design takes a turn for the future to meet today's requirements in modern LED technology.

Its characteristic design is distilled, without losing touch with its original strong form language derived from the elegant contours of a tuning-fork, nor by compromising its versatile gyroscopic principle. This allows the luminaire to tilt and rotate freely, in order to easily highlight architectural details.

Diapason is redesigned exclusively for LED lightsources and offers great flexibility to fit the needs of your project. Different colour temperatures and CRI characteristics will be available and the light effect can be customised with a variety of lenses, glare preventors and the best performing optics.

Diapason no longer comes in just two sizes, but the product range will be extended with a third, smaller luminaire: Diapason 40, allowing a wide variety of applications in residential projects, hospitality and retail applications.

First of all, Diapason 80 will be launched. Followed by the smaller Diapason 40 and the largest of the range: Diapason 120.

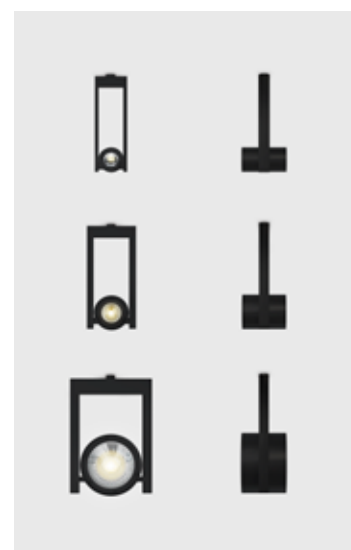

Diapason 80

Diapason 80 is a directional spotlight for indoor applications available in black and white, and equipped with LEDs of either 2700K or 3000K. The adjustability of Diapason without the use of tools, allows the luminaire to tilt and rotate for easy positioning of the spotlight in the desired position. This flexibility makes Diapason 80 suitable for both residential and hospitality projects. A wide range of light sculpting accessories is available to adjust the lighting effect. The fixture can be mounted with a M10 nipple or a round base. The use of a plasterkit ensures a seamless finish of the Diapasons base, while the installation kit with trim allows installation without plastering.



Diapason 80 white M10



Diapason 80 black with round base

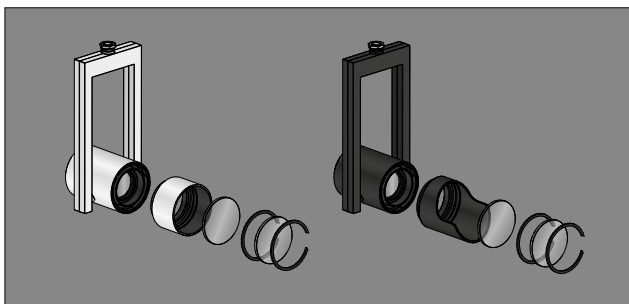

Installation of glare preventors and lenses in Diapason 80



Holon

Maximum light experience in minimal form

Holon's timeless design enables this fitting to find application in a vast range of projects. The range includes two sizes 40 and 80, both available in fixed and adjustable versions.

Holon is designed to use the best LEDs and optics to guarantee solutions for highlighting objects or enhancing spaces. The smaller version, Holon 40, is the appropriate fixture for residential projects. Holon 80 is suitable for spaces where the demands on light performance are higher.

With a perfect light quality and top performance, this range is a solution for a large number of lighting tasks.

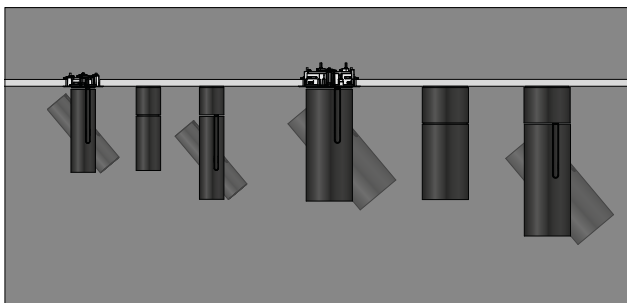

Holon 40 and Holon 80



Holon 40

Holon 40 directional, is a series of directional spotlights for indoor applications. With its off-set positioned hinge at well above 50% of the luminaire size and despite the simple design, Holon 40 directional captures a minimalist but highly decorative atmosphere.

The hinge is permanently tensioned, allowing the luminaire to remain fixed at any angle.

Holon 40 directional can be installed either recessed or surface mounted.

Holon 40 is designed for rooms that embrace its language of form but do not require an adjustable luminaire head. Holon 40 directional and Holon 40 are designed for use in residential applications and engineered only for LED. Warm color LED's with high CRI ratings allow for aesthetically, pleasant illumination.



Holon 40 directional white



Holon 40 fixed



Holon 80

Holon 80, the larger counterpart of Holon 40, is a product range of directional spotlights and downlights. The luminaire can be equipped with LED and LED retrofit lightsources. Various options in LED colour temperature, beam angles, lenses and drivers are available to optimize the desired light effect for each project, either residential or hospitality.

Holon 80 directional rotates 360° and tilts up to 90°. The hinge of Holon 80 directional is permanently tensioned, allowing the luminaire to remain fixed at any angle, from 0° to 90°. In addition to the directional spotlight, this product range comes with a second variety: Holon 80 fixed. This downlight is designed for rooms that embrace the language of form of this luminaire, but don't require an adjustable luminaire head.



Black Holon 80 directional
recessed mounted



White Holon 80 fixed



Esprit

Minimalistic twigs sprouting from floors and ceilings

Esprit, is a slim-lined projector with one or two adjustable lamp heads equipped with warm colour LEDs and a CRI variety ensuring an output of 200lm each.

The lamp head can be rotated 355° and placed in any random angle from 0° to 90°.

The luminaire is available in white or black as a ceiling mounted spotlight with a discrete circular base or as a free-standing luminaire with a rectangular base. The base comes in white carrara marble or natural blue steel.



Esprit double floor black with blue steel base



Esprit double ceiling white



Wabi

Compact architectural detail in the outdoor area

Wabi is an outdoor projector for residential projects. This small luminaire is available with a 230V LED lightsource, a 40° beamangle and a colour temperature of either 2700K or 3000K. An optional straight glare preventor can be ordered seperately.

The lamp head can be turned 360° and inclined up to 90°. The inclination of the luminaire can be set easily by using the marks indicated on the fixture and is lockable.

With the use of the optional installation accessories, this small luminaire is suitable for installation on a wide range of outdoor surfaces, like concrete, gravel and soil.



Wabi 80



Wabi 80 with glare preventor



Fuga

Light as an abstract geometric language

Fuga is a pendant lighting fixture that reclaims the creativity of the architect to interact with the surrounding space. Combining the abstract geometric language of the single Fuga unit creates an independent, autonomous form – an object. With its slim profile dimensions and flexible product lay-out, a fascinating almost tragic tension between the closed, ceiling mounted and pendant, illuminated profiles is created. At the same time, a relational space develops between the object and architecture.

The lower horizontal bar includes an LED-strip with diffuser for a homogenous light output. This bar can be repositioned to an offset position or in the middle of the vertical bar. The additional possibility to rotate the lower horizontal bar makes Fuga a dynamic pendant luminaire.

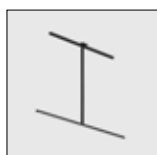

Fuga 900-1200-1200

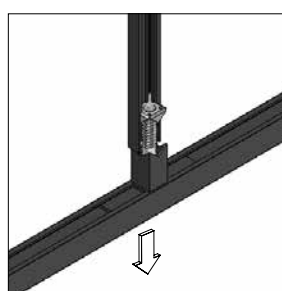

Pull down

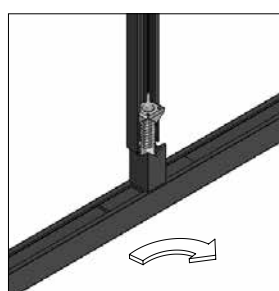

Rotate

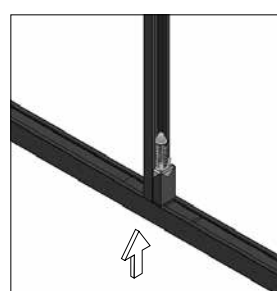

Release

Raga

Raga, every piece comes with an identity

By combining an in-depth knowledge of stone craft traditions with an empathy for the material and a concern for its lighting function, Raga becomes a product of high-object integrity. It's a distinguished lighting object with simple functional honesty that connects with a visual purity and a strong stylistic authenticity in its materialisation making each product unique. The sensitive handling of the natural material and the promotion of the basic forms make Raga a defining feature of Kreon's newly designed outdoor luminaires.



Raga horizontal nero marquina
with brushed red copper frame



Raga vertical carrara bianco
with high gloss black frame



Raga materials: metal black,
carrara bianco and nero marquina

Raga frames: high gloss black,
brushed stainless steel and
brushed red copper

